

Horizontal Single-Axis Hydraulic Tracker

MetaTracker 370



TECHNICAL FEATURES

Power Source	Connection to the main power grid (AC motor) – equipped with UPS.
Tracking Method	Astronomical Algorithm.
Range of motion	-60° to +60°.
Maximum surface	200m ² .
Ground Coverage	40 to 50%.
Structure	Galvanized elements [EN 1461, EN 10346].
Accessories	Dry and lubricated joints-Combination of stainless steel & bronze components.
Orientation	Portrait, landscape.
Dimension Limits	Flexible table length arrangements, following string arrangement (panel/string).
PV Modules	Up to 2 in portrait layout / Up to 4 in landscape layout/ Panel dimensions from 1.2 up to 2.5m.
Slope Limits	Unlimited E-W slope, up to 8° N-S, typical design. Unlimited E-W slope, up to 15° N-S for special. Slopes are smooth, structures w/ steady slopes.
Foundation	Pile ramming/Piles in holes filled with concrete / Concrete ballasts.
Wind load limits	Vb=33m/s, Terrain Category II.
Snow load limits	Sko=1.7kN/m ² , Snow Zone B.
Operation Conditions	Up to 50 km/h at any tracking angle and wind orientation.
Wind Protection	Automatically return to the stow position through anemometer.
Temperature Range	-20°C to +60°C.

Horizontal Single-Axis Hydraulic Tracker

MetaTracker 370

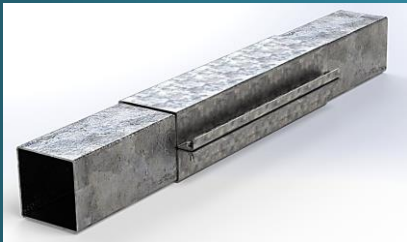
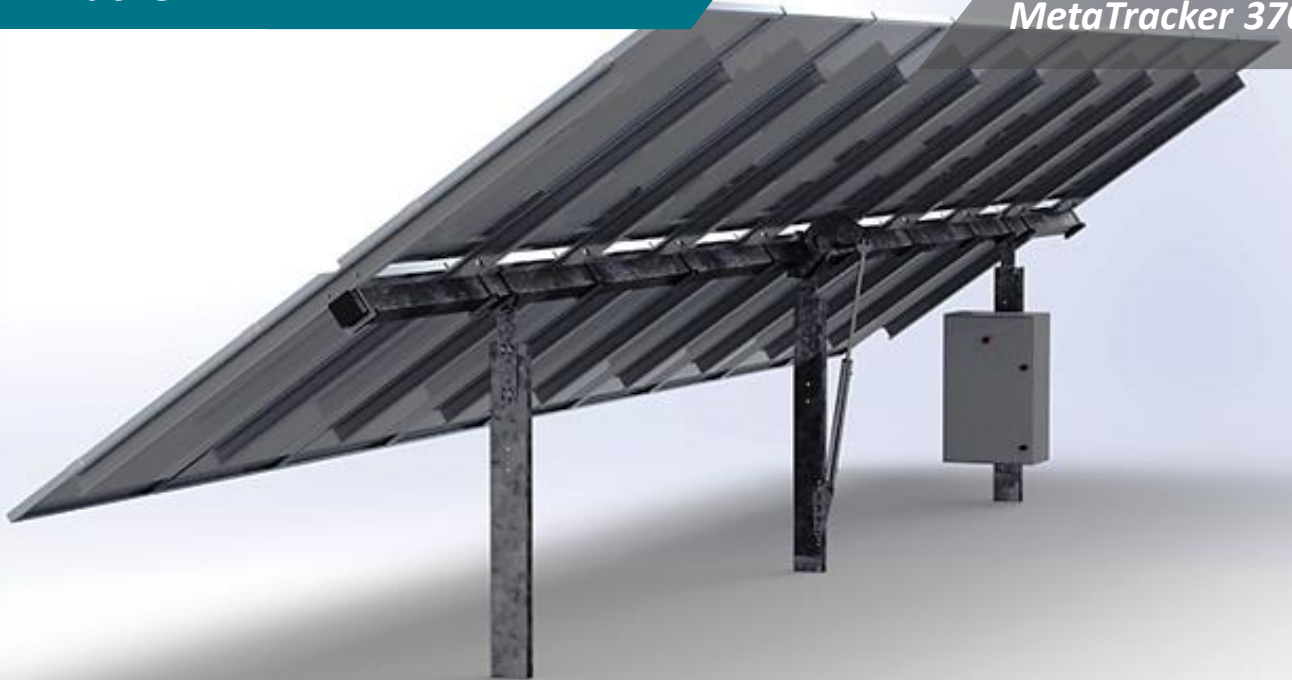

Shaft and shaft connector



Simple Pile



Torque Pile

